

ASSEMBLY INSTRUCTIONS

Steel Handle Wheelbarrow 530 & 620

Fastener Set #309440 -for steel handle models.

- (4) 2-1/2" Carriage Screws (p/n 024-398)
- (6) 2" Hex Head Cap Screws (p/n 020-397)
- (2) 1" Carriage Screws (p/n 024-311)
- (12) 5/16" flange nuts (p/n 040-781)

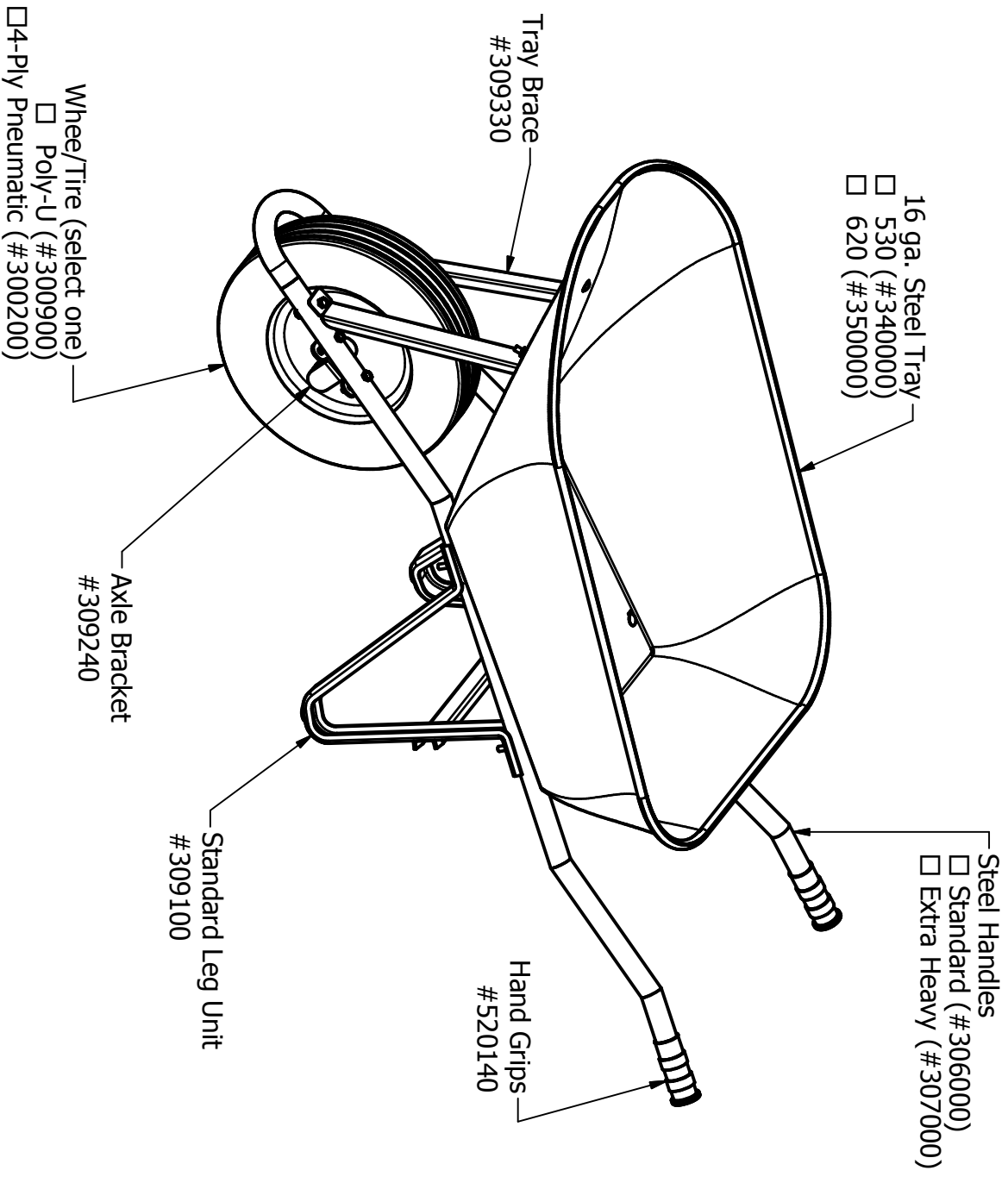

ASSEMBLY INSTRUCTIONS

Steel Handle Wheelbarrow 530 & 620

Note: Apply all nuts finger-tight only until fully assembled, then tighten with wrench.

Tray, Frame, & Leg: Insert four 2-1/2" carriage bolts through tray bottom, with bolts through holes in legs. Place legs over bolts through holes. Apply nuts loosely.

Tray Support Plate, Axle, Tray Braces: Insert two 1" carriage bolts through upper front tray holes. Place tray support plate over bolts. Place one end of each brace over each bolt. Apply Nuts. Position holes in tray braces over holes in frame. Insert two 2" cap screws through tray braces and handle/frame. Fasten axle assembly on frame with four 2" carriage bolts. Apply nuts.

Wheel Assembly: If bearings are not inserted in hubs, drive one into each end of hub.

Wheel to Axle Assembly: Put one washer inside, followed by wheel, followed by washer, followed by cotter pin. NOTE: If extra washers are needed, put extra washers inside of wheel.

